

# QCPC-M

# CLAMPING PINS



Stainless Steel

Heat resistance: 180°C



QCPC0625-M4-SUS



QCPC0834-M5-SUS

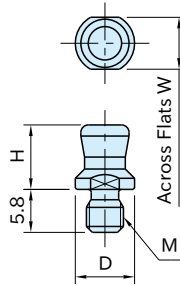

<b>Body</b>
SUS630 stainless steel Surface hardened

Part Number	D ( <sup>-0.05</sup> / <sub>-0.10</sub> )	M	H	W	Weight (g)	Proper Pin Holding Clamps	Proper Snap-In Clamps
QCPC0625-M4-SUS	6	M4×0.7	7.6	5	2	QCPC0625-10 QCPC0625-10S QCPC0625-10-SUS	QCOW0616-10SUS QCOWS0616-10SUS
QCPC0834-M5-SUS	8	M5×0.8	8.7	7	3	QCPC0834-14 QCPC0834-14S QCPC0834-14-SUS	—

Note: Refer to the product pages of clamps for machining accuracy and repeatability.

## How To Install

### Standard Installation

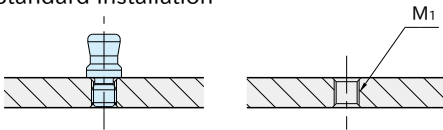

Part Number	M <sub>1</sub>	d
QCPC0625-M4-SUS	M4×0.7	7
QCPC0834-M5-SUS	M5×0.8	9

### Space-Saving Installation

Prepare a counterbored hole with depth  $0.5 \pm 0.1$  on the surface where Clamping Pin to be mounted directly contacts with the bottom surface of the clamp.

#### Pin Holding Clamp

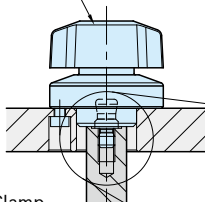

#### Snap-In Clamp

