

# CP135-L

# SPIRAL CAM CLAMPS



★Key Point  
Space saving.  
Long clamping stroke.



**CP135-AL**



**CP135-L**

Spiral Cam Clamp	Handle	Clamping Plate
SCM440 steel Black oxide finished HRC33-39	SCM440 steel Black oxide finish HRC30-35	SUS304CSP stainless steel

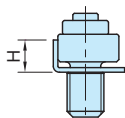
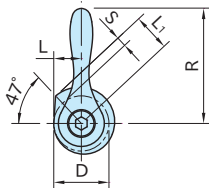
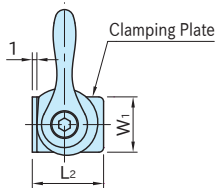

**CP135-AL**

(With Clamping Plate)

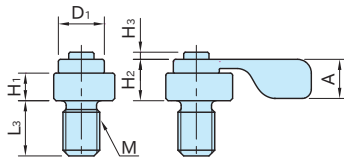

**CP135-L**

(Without Clamping Plate)

Type	S	L	L <sub>1</sub>	D	M	H <sub>1</sub>	L <sub>3</sub>	D <sub>1</sub>	H <sub>2</sub>	R	H <sub>3</sub>	A	Allowable Operating Load (N)	Clamping Force (kN)
<b>CP135-08001</b>	2.2	6	8.2	12	M 8×1.25	6	12	10	9	25	1.5	8.5	50	0.3
<b>CP135-10001</b>	2.5	7	9.5	14	M10×1.5	7	15	12	11	30	1.8	10	70	0.5
<b>CP135-12001</b>	2.9	8	10.9	16	M12×1.75	8	18	14	13	40	2.2	12	100	0.7

## CP135-AL (With Clamping Plate)

Part Number	H	W <sub>1</sub>	L <sub>2</sub>	Clamping Plates	Weight (g)
<b>CP135-08001AL</b>	7	12	15.5	CP135-08001P	19
<b>CP135-10001AL</b>	8	14	18	CP135-10001P	32
<b>CP135-12001AL</b>	9	16	20	CP135-12001P	54

## CP135-L (Without Clamping Plate)

Part Number	Weight (g)
<b>CP135-08001L</b>	17
<b>CP135-10001L</b>	30
<b>CP135-12001L</b>	51

## Feature

- The spiral cam provides quick and powerful clamping.
- The simple design keeps cost low and the small size allows more workpieces per load.
- Clamping Plate avoids marring workpiece surfaces.

## How To Use

### Mounting Hole Dimension

With Clamping Plate

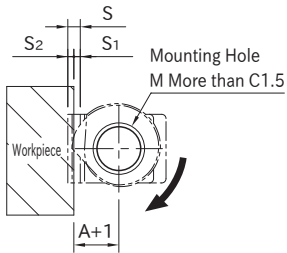

Without Clamping Plate

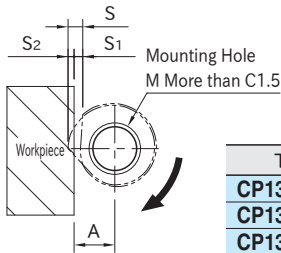

Type	A	S	S <sub>1</sub>	S <sub>2</sub>	M
CP135-08001	7.1	2.2	1.1	1.1	M 8x1.25
CP135-10001	8.3	2.5	1.3	1.2	M10x1.5
CP135-12001	9.5	2.9	1.5	1.4	M12x1.75

Note: Dimension A and A+1 are the recommended distances between the mounting hole and the end of the workpiece.

### How to Install Handle

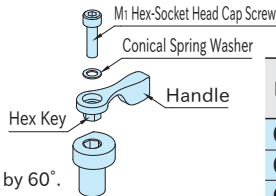
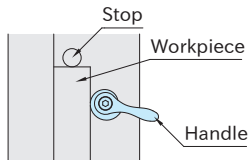

Part Number	M <sub>1</sub>	Recommended Tightening Torque (N·m)
CP135-08001L	M3x0.5	1.2
CP135-10001L	M4x0.7	3
CP135-12001L	M5x0.8	6

The handle position is adjustable by 60°.

### Note

Tighten Spiral Cam Clamp fully and loosen it about one turn. Then mount a workpiece.

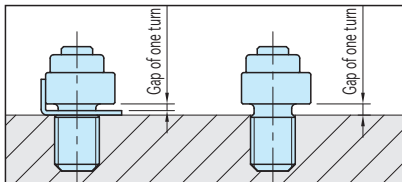

- Tighten clockwise to clamp the workpiece.
- Mount a stop on the right side of the workpiece.

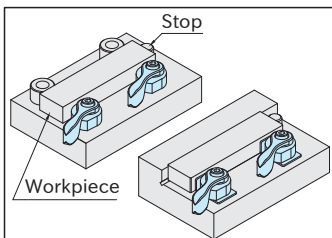

### CP135-P

### Clamping Plates



### CP135

### SPIRAL CAM CLAMPS



Without handle type is available.